

---

# LED Parking Garage Specification

## YR-PG230 Series

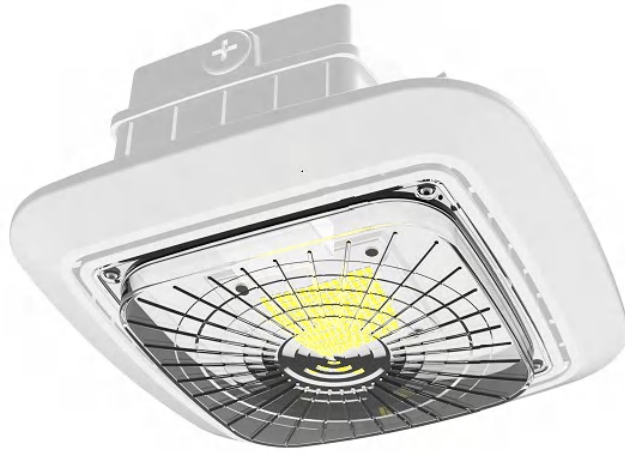

---

### I . Application :

Parking garage, warehouse, parking buildings, stair way, interior canopies.

---

### II . Features:

1. High performance, up to 130lm/W;
  2. Super wide 160DEG beam angle, High transmittance optic PC lens;
  3. Hanging type internal wiring, anti-slip design back cover, easy installation and high safety;
  4. IP66 rated, suitable for wet locations;
  5. 3-in-1 dimming, 1-10V, PWM, Resister;
  6. Occupancy sensor available;
  7. Operating temperature rating of  $-40^{\circ}$  F to  $122^{\circ}$  F ( $-40^{\circ}$  C to  $50^{\circ}$  C )
  8. White/Bronze housing powder coat finish, 5 years warranty
-

### III. Product Size:

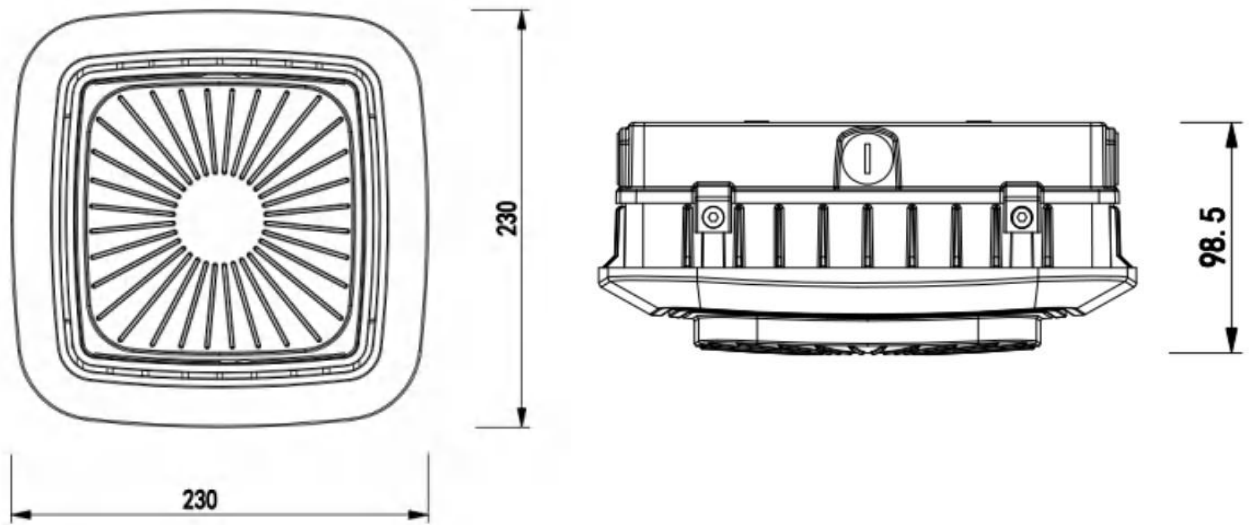

### IV. Technical Parameter:

Model	System Power	CCT	CRI	Luminous Flux	Size (MM)	Certificate
YR-PG230-W30	30W	3000-5700K	≥80	>130LM/W	230*230*98.5	ETL,DLC,CE,ROHS
YR-PG230-W50	50W	3000-5700K	≥80	>130LM/W	230*230*98.5	ETL,DLC,CE,ROHS
Input Voltage: AC100~ 277V/305V AC180~ 528V IP66 IK08 LED Chips: 2835						
Storage temperature: - 40 ~ + 65 °C						

### V. Beam Angle:

TYPE V 160°

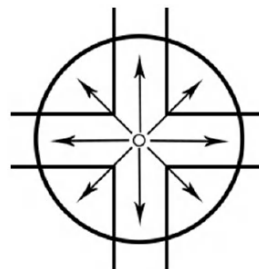
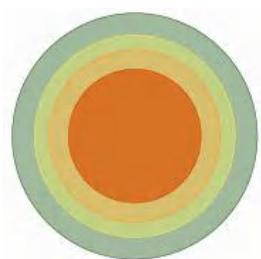

---

## VI. Installation Instruction

### 1. Surface Ceiling Mounting

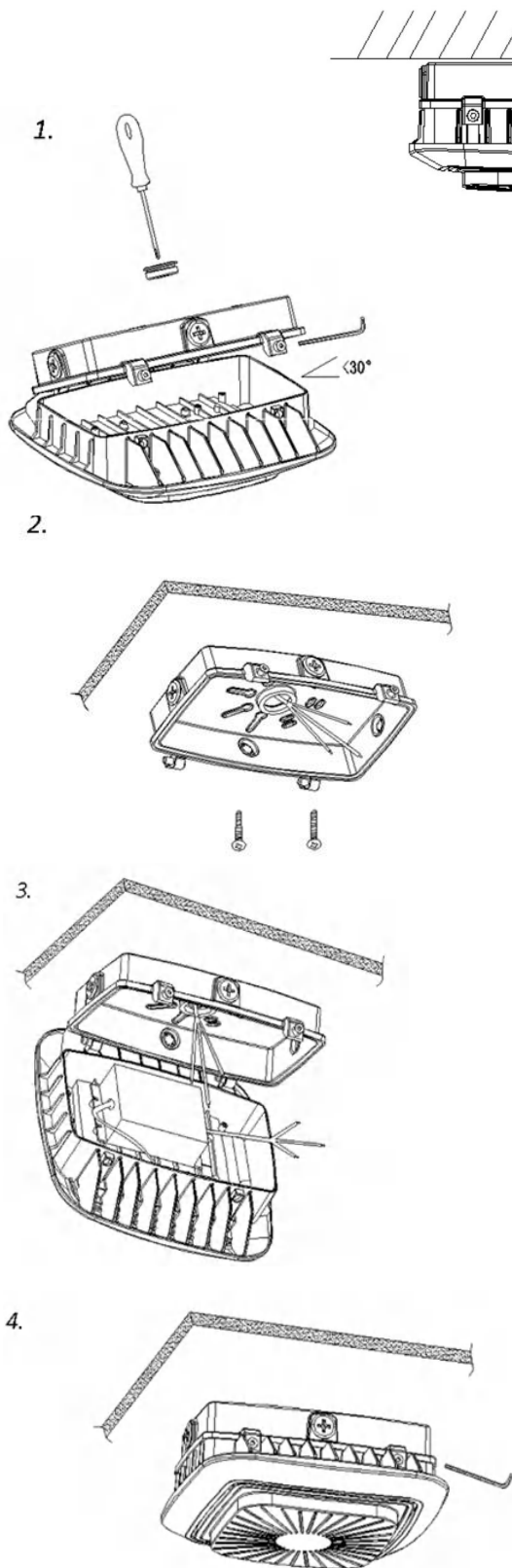

1. Remove the 3/4 plug with a cross screwdriver and take it out. After loosening the screw with an Allen wrench, keep the back cover opened ( the angle is less than  $30^{\circ}$  ) and take it out after turning over.

2. Cut off the power supply, use tools to knock out the corresponding installation holes of the back cover, put the input wire through the hole, fix the back cover on the ceiling with screws, and make necessary waterproof protection.

3. Hang the lamp on the back cover at less than 30 degrees, let the lamp fall naturally, and then connect Live line, Neutral line and Earth line.

4. Turn over and close the lamp body, lock the screw with the Allen wrench, and install it.

## 2. Pendant Mounting

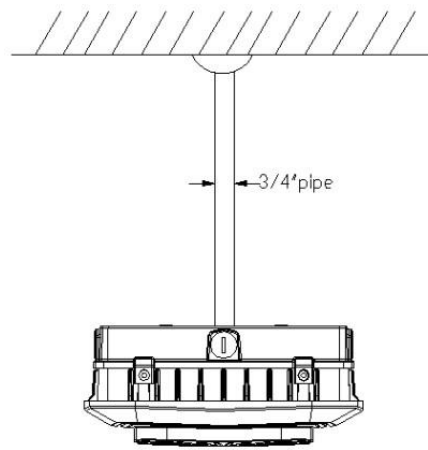
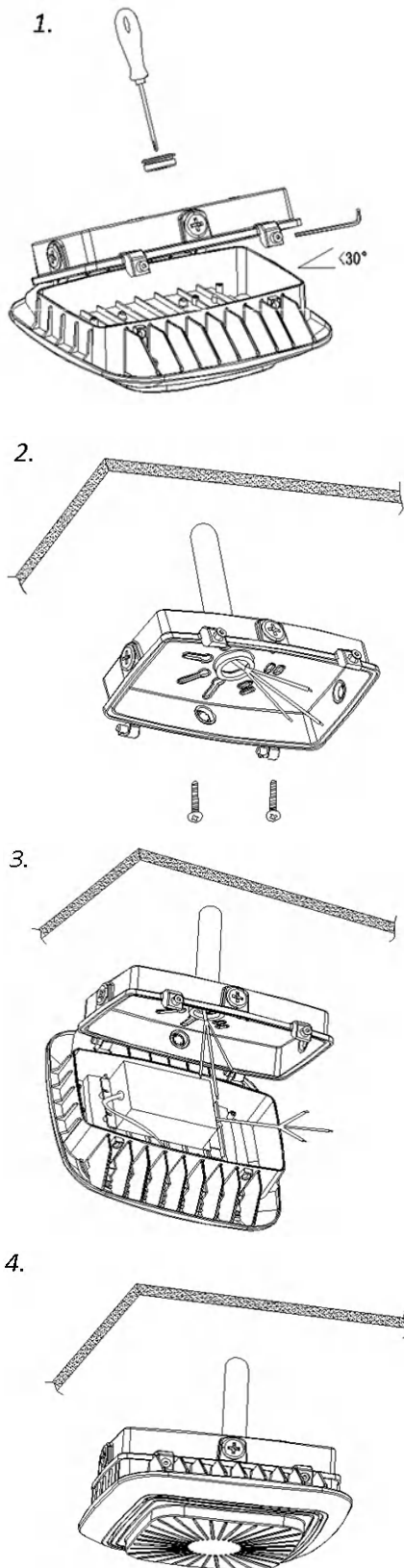

1. Remove the 3/4 plug with a cross screwdriver and take it out. After loosening the screw with an Allen wrench, keep the back cover opened ( the angle is less than 30 ° ) and take it out after turning over.

2. Cut off the power supply, rotate the back cover into the 3/4 thread pipe, put the input wire through the hole and make necessary waterproof protection.

3. Hang the lamp on the back cover at less than 30 degrees, let the lamp fall naturally, and then connect Live line, Neutral line and Earth line.

4. Turn over and close the lamp body, lock the screw with the Allen wrench, and install it.

### 3. Horizontal Mounting

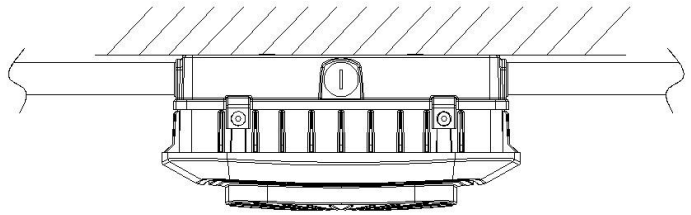
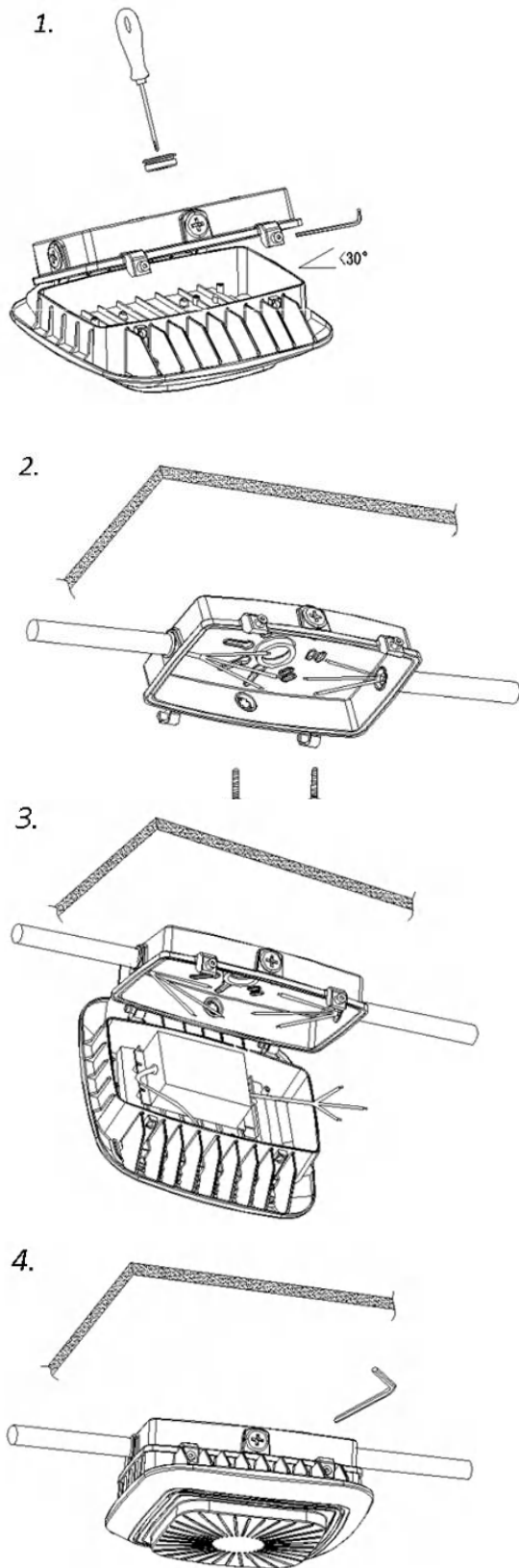

1. Remove the 3/4 plug with a cross screwdriver and take it out. After loosening the screw with an Allen wrench, keep the back cover opened ( the angle is less than  $30^{\circ}$  ) and take it out after turning over.

2. Cut off the power supply, rotate the back cover into the 3/4 thread pipe, put the input wire through the hole and make necessary waterproof protection.

3. Hang the lamp on the back cover at less than 30 degrees, let the lamp fall naturally, and then connect Live line, Neutral line and Earth line.

4. Turn over and close the lamp body, lock the screw with the Allen wrench, and install it.

---

## VII. Package Information:

Item	Inner box (MM)	G.W.	Outer carton (MM)	G.W.
YR-PG230-W30	255*135*260	2.4kg/5.3lbs	560*265*280	10.5kg/23.1lbs
YR-PG230-W50	255*135*260	2.5kg/5.5lbs	560*265*280	10.9kg/24.0lbs

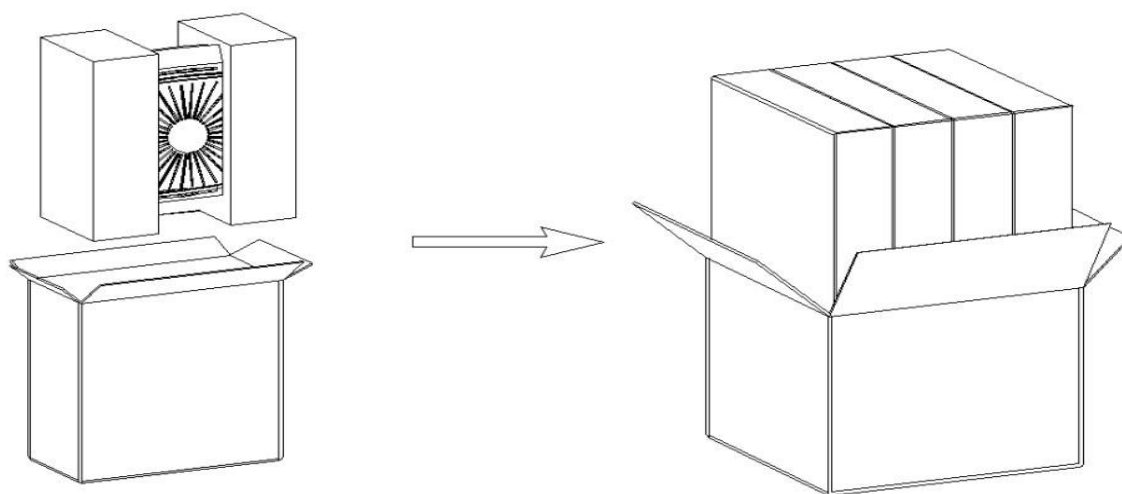

## VIII. Installation and maintenance:

1. Please cut off the power supply before maintenance;
2. Clean the lens surface regularly to maintain high light transmittance;
3. Clean the dust on the radiator regularly to keep high heat dissipation;
4. Not to clean it with water or corrosive solution, preferably wipe with dry cloth;
5. When installing or replacing the power supply, directly open the back cover with a screwdriver, and replace it with a new one;
6. Please make sure the input voltage matches the lamp before connecting to the power.